

ITEM NO.	PART NUMBER	DESCRIPTION	QTY.
10	MACH-004181	BODY, CTS, CI31	1
20	MACH-004248	Cap, CTS, CI31	1
30	MACH-054205	Stem, CTS, CI31-E3.0	1
40	SEAL-005436	CI31-ORING 109	1
50	SEAL-005438	CI31-ORING 216	1
60	MACH-004303	Nose, CTS, CI31-SAE-G	1
70	SEAL-004797	Seal, CTS, CI31-SAE-G	1
80	MACH-004435	Washer, CTS, CI31-SAE-G	1
90	MACH-004578	Spacer Extension, CTS, CI31	3

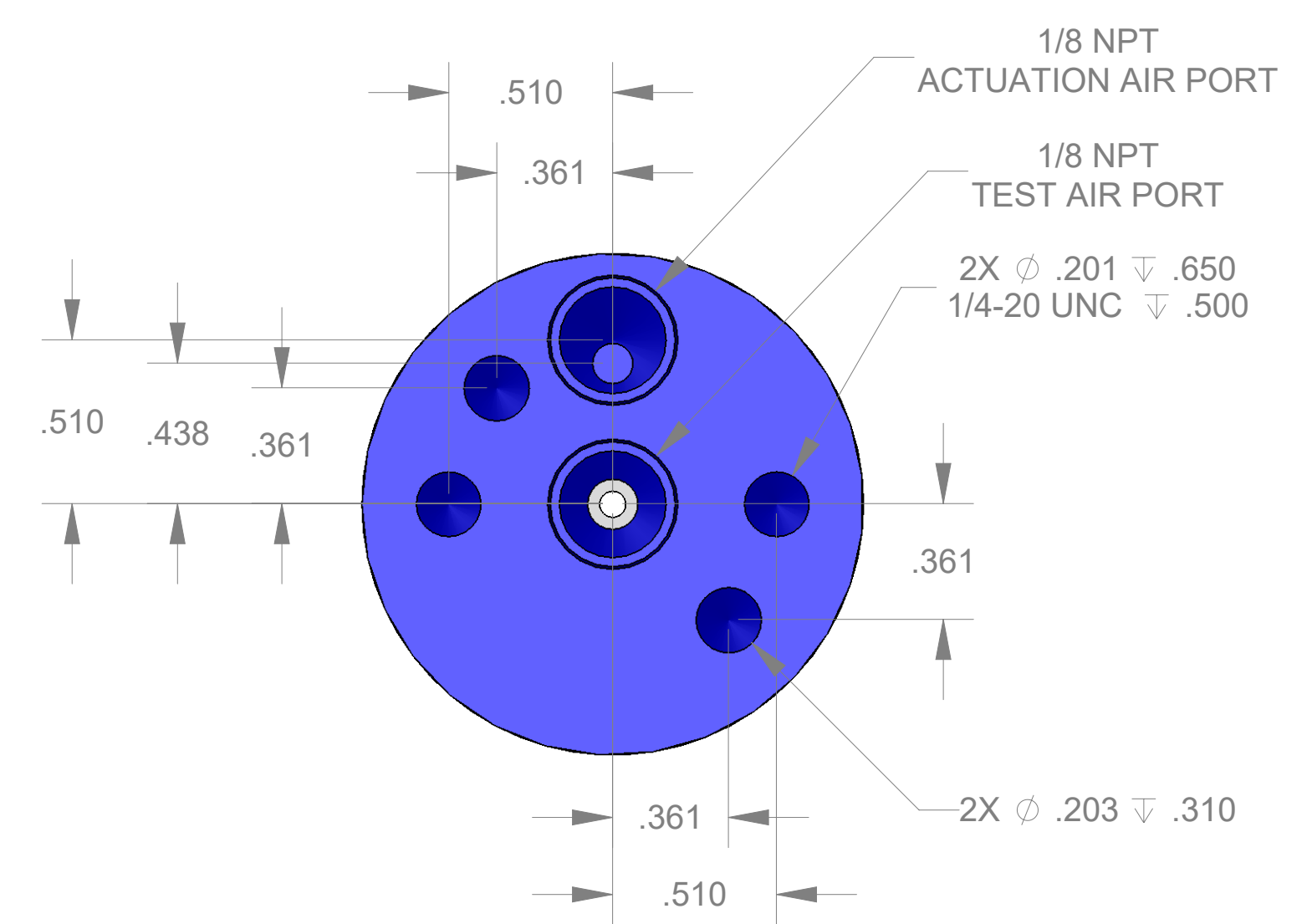

SECTION A-A

REVISIONS			
REV.	DESCRIPTION	DATE	APPROVED
A	Initial Release	02-13-2026	KM
B	Nose material changed from brass to 316 stainless steel	04-06-2026	KM

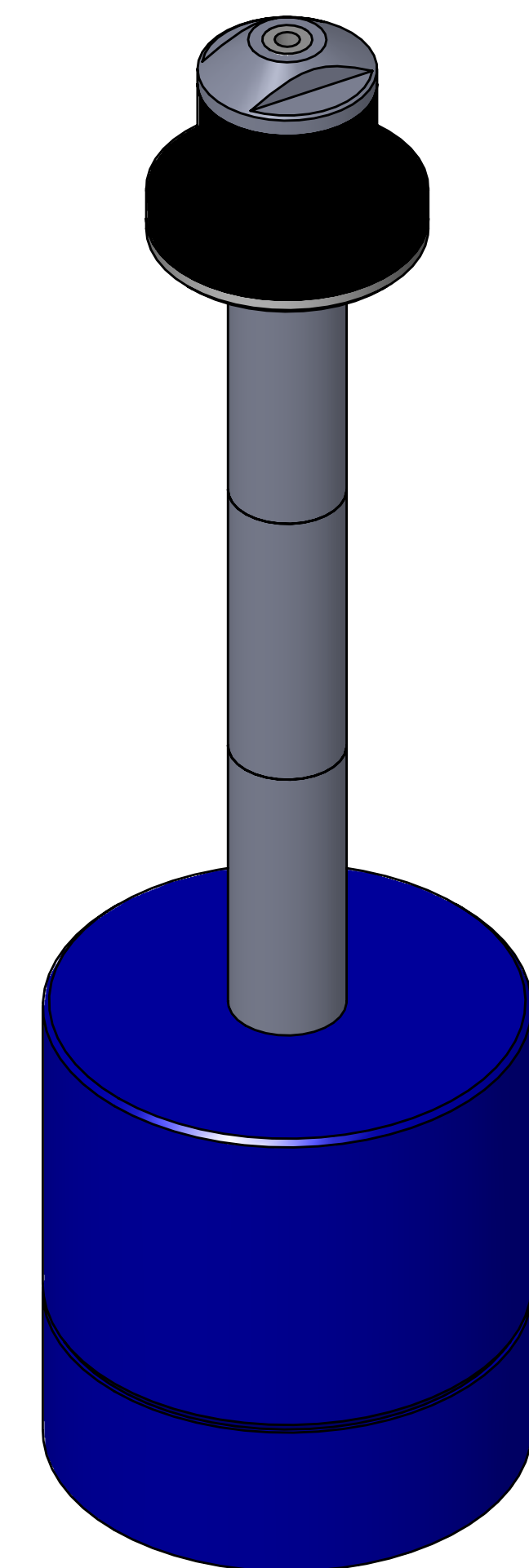

SIZE	D	DESCRIPTION	Connect Assembly, CTS, CI31-SAE-0687-E3.0
PART NUMBER	CTSC-002426		REV B
DATE	7/19/05	DRAWN BY	KM CHECKED BY KM SHEET 1 OF 1

FILE LOCATION: C:\PDM\PDM\R&D Product Development\CTS Connects\CI\Connect Assembly\Standard\CI31\3in Stem Extension\CTSC-002426

Monday, April 6, 2026