

SECTION A-A

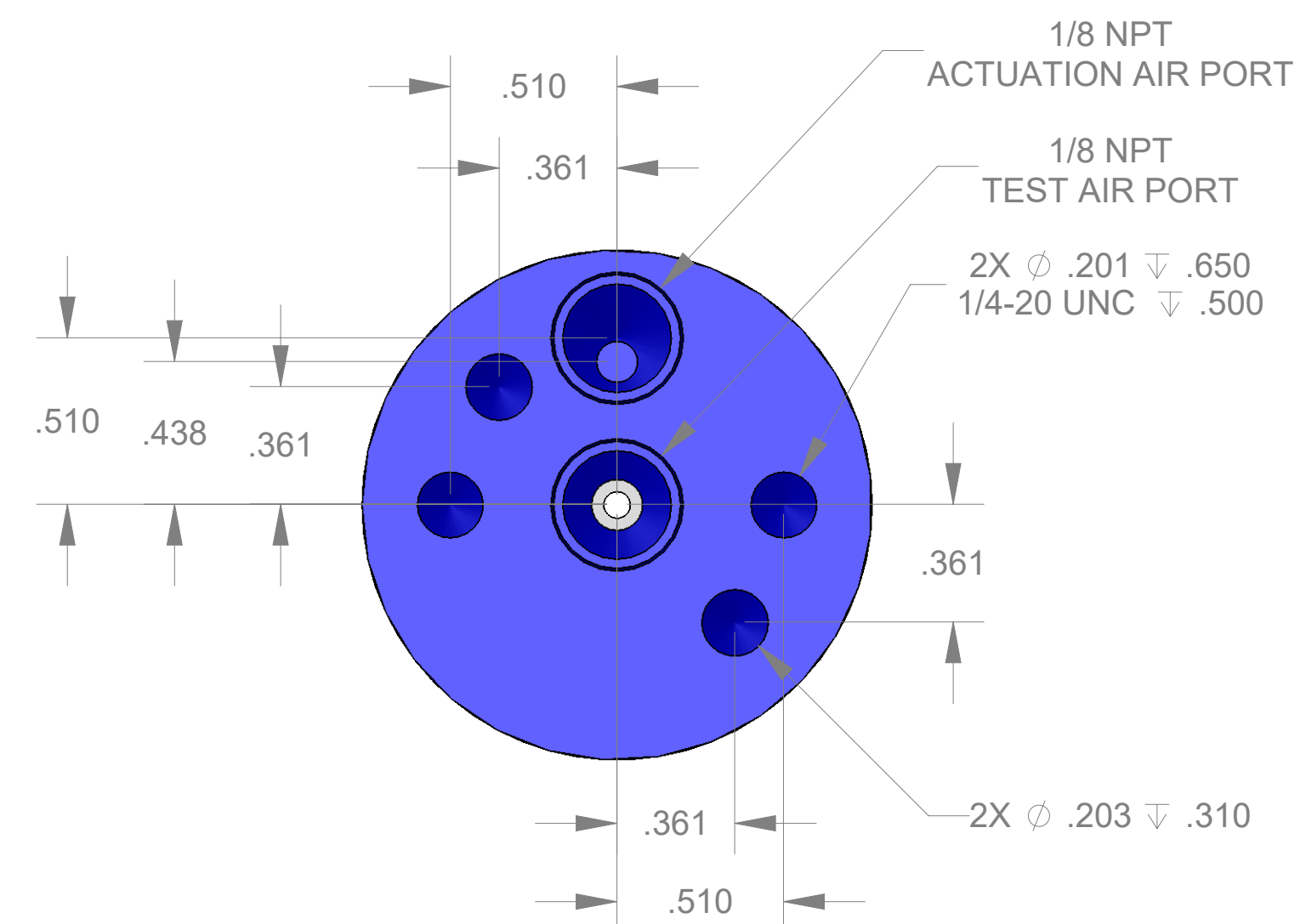

ITEM NO.	PART NUMBER	DESCRIPTION	QTY.
10	MACH-004181	BODY, CTS, CI31	1
20	MACH-004248	Cap, CTS, CI31	1
30	MACH-054205	Stem, CTS, CI31-E3.0	1
40	SEAL-005436	CI31-ORING 109	1
50	SEAL-005438	CI31-ORING 216	1
60	MACH-004297	Nose, CTS, CI31-MET-C	1
70	SEAL-004781	Seal, CTS, CI31-MET-C	1
80	MACH-004430	Washer, CTS, CI31-MET-C	1
90	MACH-004578	Spacer Extension, CTS, CI31	3

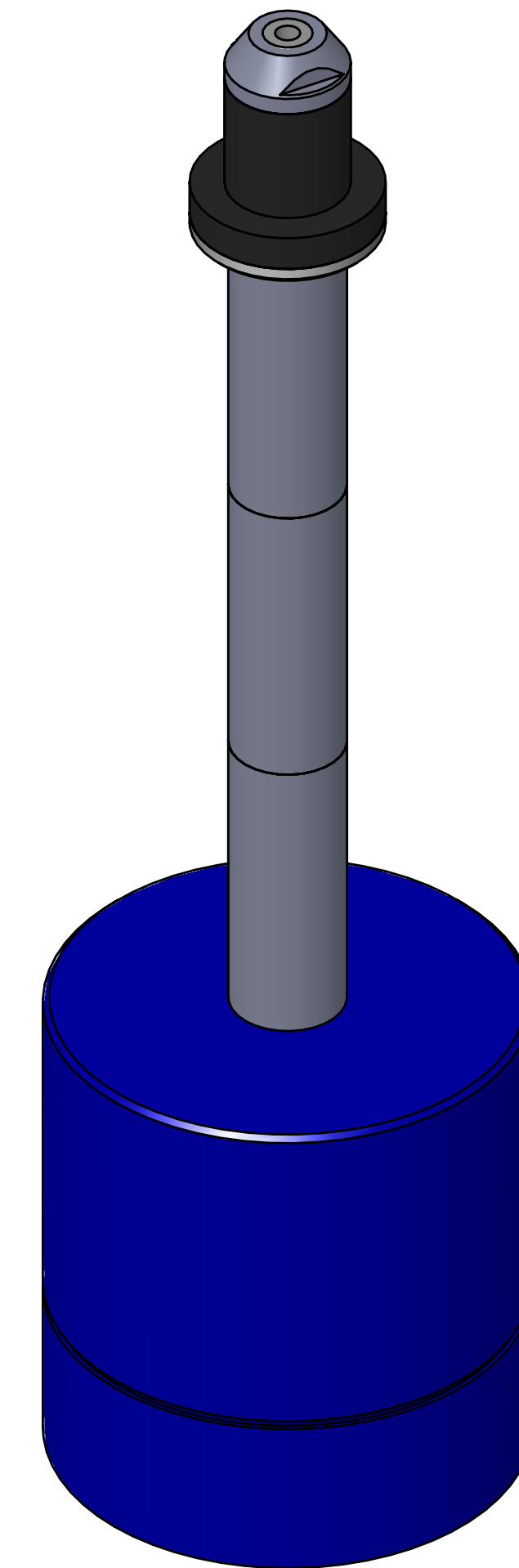

REVISIONS			
REV.	DESCRIPTION	DATE	APPROVED
A	Initial Release	02-11-2026	KM
B	Nose material changed from brass to 316 stainless steel	04-06-2026	KM



SIZE	DESCRIPTION	REV
D	Connect Assembly, CTS, CI31-M12-E3.0	B
PART NUMBER	DATE	DRAWN BY
CTSC-002146	7/19/05	KM
CHECKED BY	SHEET	OF
KM	1	1

FILE LOCATION: \\PDM\PDM\R&D\Product Development\CTS Connects\C\Connect Assembly\Standard\CI31\3in Stem Extension\CTSC-002146

Monday, April 6, 2026