

SECTION A-A

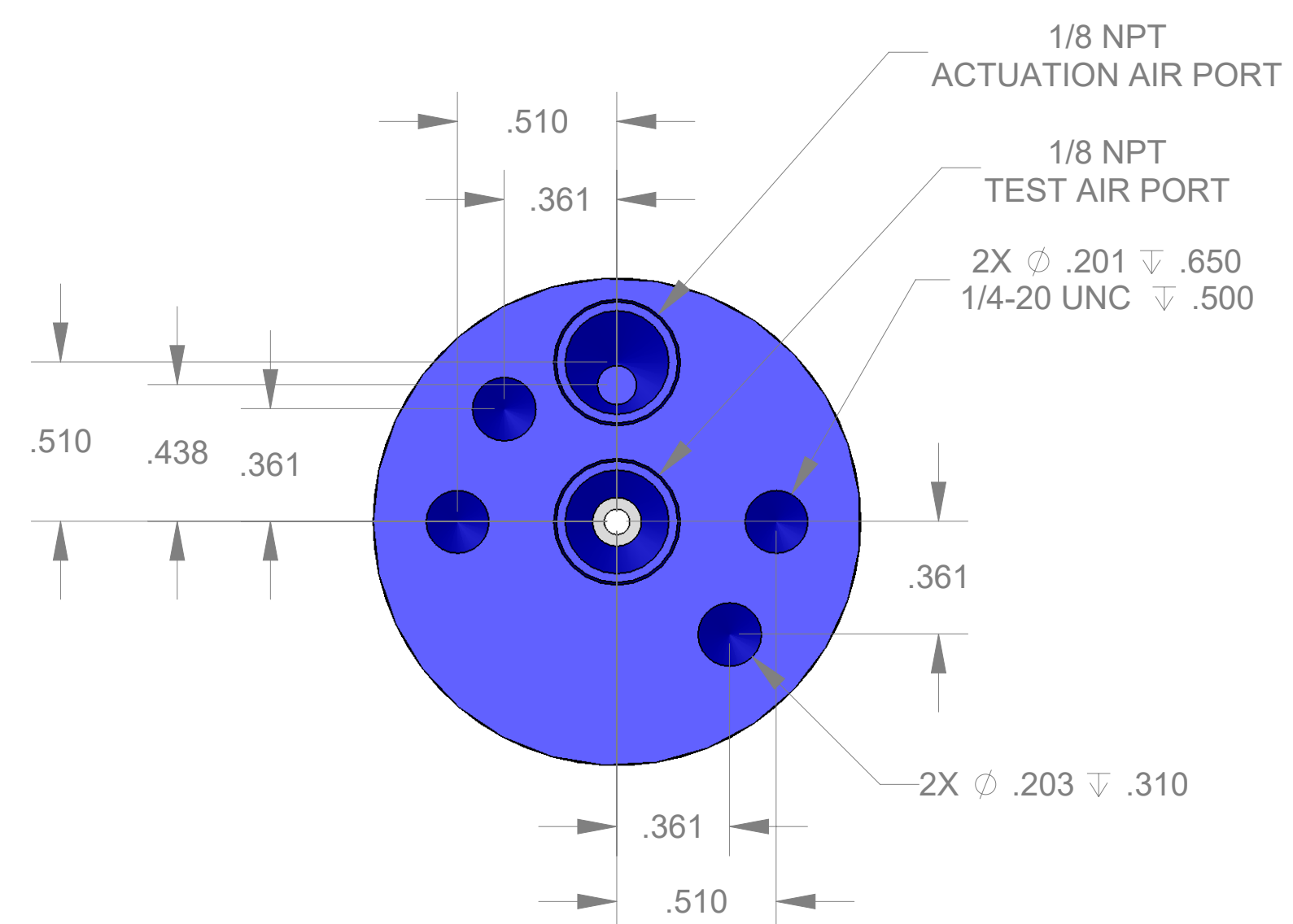

| ITEM NO. | PART NUMBER | DESCRIPTION | QTY. |
|----------|-------------|-----------------------------|------|
| 10 | MACH-004181 | BODY, CTS, CI31 | 1 |
| 20 | MACH-004248 | Cap, CTS, CI31 | 1 |
| 30 | MACH-054205 | Stem, CTS, CI31-E3.0 | 1 |
| 40 | MACH-004577 | Spacer, CTS, CI31 | 1 |
| 50 | SEAL-005436 | CI31-ORING 109 | 1 |
| 60 | SEAL-005438 | CI31-ORING 216 | 1 |
| 70 | MACH-004293 | Nose, CTS, CI31-AC | 1 |
| 80 | SEAL-004773 | Seal, CTS, CI31-AC-M | 1 |
| 90 | MACH-004428 | Washer, CTS, CI31-AC | 1 |
| 100 | MACH-004578 | Spacer Extension, CTS, CI31 | 3 |

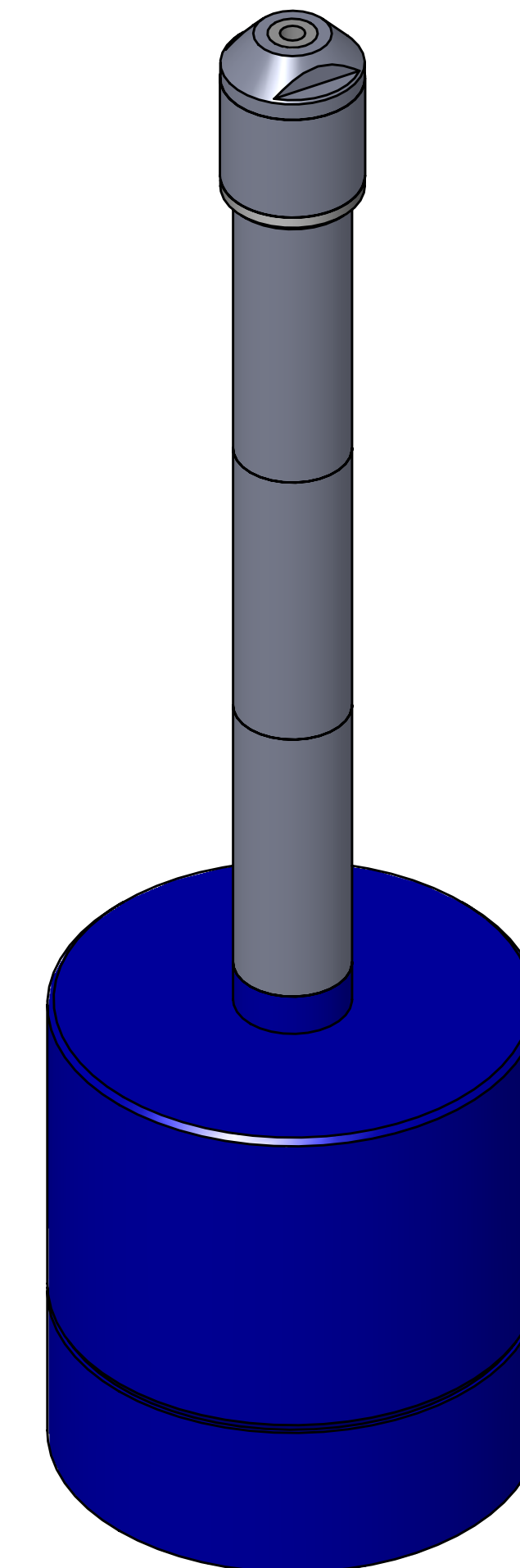

| REVISIONS | | | |
|-----------|-----------------------------------|------------|----------|
| REV. | DESCRIPTION | DATE | APPROVED |
| A | Initial Release | 03-13-2026 | KM |
| B | Changed material of nose and seal | 03-16-2026 | KM |



10100 PROGRESS WAY HARRISON, OH 45030

| | | |
|-------------|---------------------------------------|----------------|
| SIZE | DESCRIPTION | REV |
| D | Connect Assembly, CTS, CI31-AC-E3.0-M | B |
| PART NUMBER | CTSC-001546 | |
| DATE | DRAWN BY: KM | CHECKED BY: KM |
| | SHEET 1 | OF 1 |

FILE LOCATION: C:\PDM\PDM\R&D\Product Development\CTS Connects\C\Connect Assembly\Medical\CI31-M\3in Stem Extension\CTSC-001546