

SECTION A-A

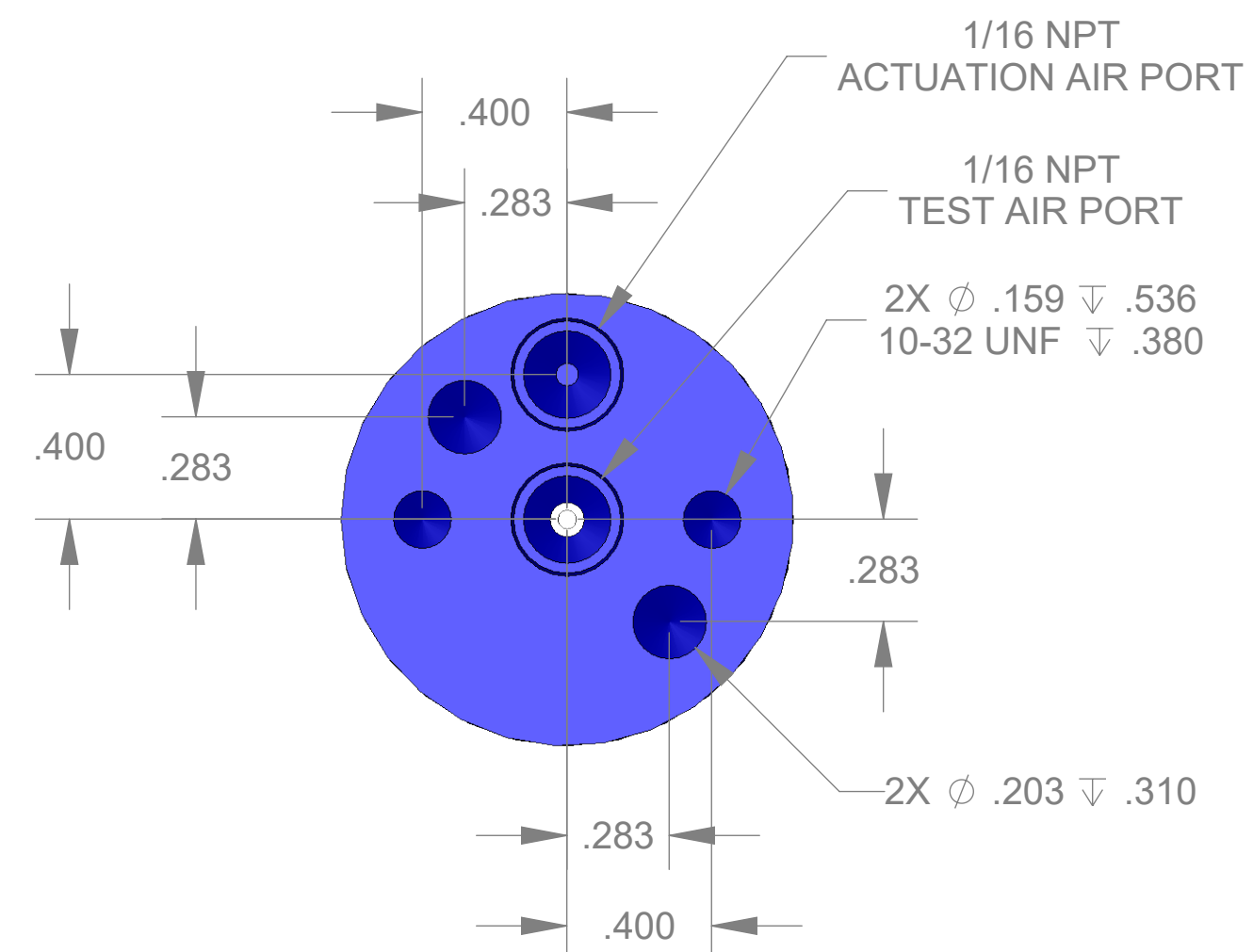

| ITEM NO. | PART NUMBER | DESCRIPTION                 | QTY. |
|----------|-------------|-----------------------------|------|
| 10       | MACH-004180 | BODY, CTS, CI30             | 1    |
| 20       | MACH-004247 | Cap, CTS, CI30              | 1    |
| 30       | MACH-004275 | Nose, CTS, CI30-A1          | 1    |
| 40       | MACH-004416 | Washer, CTS, CI30-A1        | 1    |
| 50       | MACH-004571 | SPACER, CTS, CI30           | 1    |
| 60       | MACH-054202 | Stem, CTS, CI30-E4.0        | 1    |
| 70       | SEAL-004717 | Seal, CTS, CI30-A1-M        | 1    |
| 80       | SEAL-005446 | CI30-ORING 009              | 1    |
| 90       | SEAL-005447 | CI30-ORING 119              | 1    |
| 100      | MACH-004572 | Extension Spacer, CTS, CI30 | 4    |

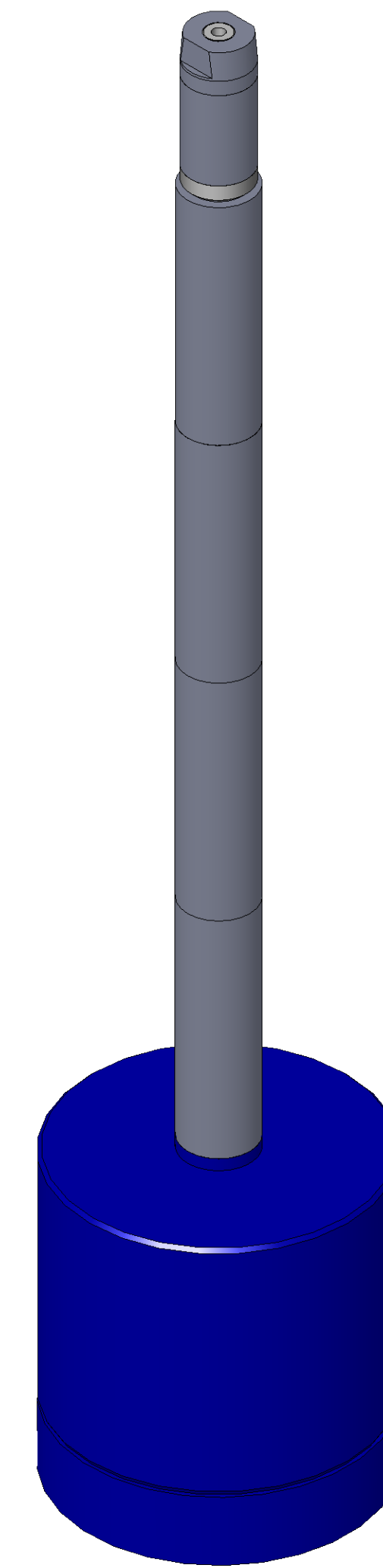

| REVISIONS |                                   |            |          |
|-----------|-----------------------------------|------------|----------|
| REV.      | DESCRIPTION                       | DATE       | APPROVED |
| A         | Initial Release                   | 01-29-2026 | KM       |
| B         | Changed material of nose and seal | 03-16-2026 | KM       |



|             |             |             |                                       |
|-------------|-------------|-------------|---------------------------------------|
| SIZE        | D           | DESCRIPTION | Connect Assembly, CTS, CI30-A1-E4.0-M |
| PART NUMBER | CTSC-001444 |             | REV B                                 |
| DATE        | DRAWN BY    | CHECKED BY  | SHEET 1 OF 1                          |

FILE LOCATION: C:\PDM\PDM\R&D\Product Development\CTS Connects\CI\Connect Assembly\Medical\CI30-M\4in Stem Extension\CTSC-001444